

# Help Us Grow

## Become a Member!

Benefits Include.....

### Pine \$30

- Our quarterly newsletter *Arborescent*
- 10% discount in the Gift Shop
- Class discounts
- Advance notification of special events, and classes
- Library checkout privileges.

### Fir \$50 & Maple \$75

- All Pine benefits are extended to your immediate family

### Spruce \$100

- All the above benefits plus one free class

### Walnut (Best Friend) \$300

- All the above benefits plus 2 complimentary Garden Tour tickets

### Cedar (Sponsor) \$500 +

- All the above benefits plus 2 complimentary Autumn Bounty tickets

## Dedicate a Memorial or Honorarium to a Special Friend or Loved One by...

- Engraving a brick in our Founders Courtyard. A perfect way to mark a special occasion.
- Planting a tree with a memorial plaque. A wonderful way to honor a loved one. A symbol of life

## Give the Gift of Membership

We will acknowledge your gift by sending the recipient a set of beautiful gift cards and a personal thank you card.

## Donate to our

## Endowment or General Fund

We rely on your generosity to maintain our numerous gardens and trees, *and* for the events and classes that enrich the Arboretum experience.

**21 DOUGLAS-FIR, LARCH, & INCENSE CEDAR**  
Douglas-fir is of a different genus than that of the true firs. Larch needle-leaves are deciduous - i.e., larch is a deciduous conifer. A long border row of incense cedars stands as a windbreak, and a visual and sound barrier.

**22 GINKGO**  
Another of the prehistoric species, this tree dominated the local landscape millions of years ago. Fossilized remnants are featured at Ginkgo-Wanapum State Park near Vantage on the Columbia River.

**23 RAISED BED VEGETABLE GARDEN**  
In tending this garden, volunteers utilize Integrated Pest Management concepts, including beneficial insects, floating row covers, crop rotations, mulching, bats and birds, and plants resistant to pests, weeds and diseases. The beds are constructed of "plumber," or recycled durable plastic lumber. The trellises are built from recycled fruit tree props.

### XERIC GARDEN DEMONSTRATION SITE

This project, adjacent east of the Jones Center, is sponsored by the WA State Department of Ecology & Yakima County Solid Waste. Xeriscape gardening is the planning and developing of a landscape that uses little additional water to maintain its environment. Notice the buffalograss turf and the straw bale wall and arch.

### HAROLD JONES NURSERY CENTER & WALTER FESER CLASSROOM

The Jones Center is a service and maintenance facility for the gardener and work parties, and is home to the annual spring plant sale. The new Feser Classrooms are located in the central and east end of the building, and will be used for plant study and future nature day camps. The Arboretum's caretakers reside in the house nearby.

### KARA KONDO DRYLAND GARDEN

Located in the parking lot south of the Jones Center is the Kara Kondo Dryland Garden. This garden demonstrates the use of water-wise plants for landscaping. The only moisture these plants receive is natural precipitation. Located toward the north end are native plants and adapted non-native plants, while cacti and succulents occupy the south end.

**24 BEECH COLLECTION**  
Among the beeches, the contorted one shows well when snow covers the curving branches. Beeches have smooth gray bark, and produce edible nuts encased in prickly husks.

**25 ROSE GARDEN & YELLOW DISPLAY GARDEN**  
The Rose Garden with its pathway, benches, fountain, and memorials within the beds, is managed by the Lower Naches Garden Club. The nearby bed of yellow flowers is maintained by the Nature Artists Garden Club.

### ORIENTEERING COURSE

The grid marker south of the flagpole near the Rose Garden also marks the start of the Orienteering Course. The Course is used by individuals and groups, such as Yakima County Search and Rescue, to hone compass navigation skills.

**26 BLOSSOM FIREWORKS**  
In mid-April an explosion of ornamental fruit blossoms is infused with myriad white to pink to red tints of flowering cherry, plum, crabapple, pear, and peach.

**27 NUT COLLECTION**  
This collection includes black walnut, English walnut, almond, Japanese heartnut and pecan.

**28 MAPLE COLLECTION**  
Maples are noted for fall color, and range from large shade trees to small, shrubby accent trees. All have opposite leaves. The fruits are paired, winged seeds in doubles called samarae or keys.

**29 UTILITY FRIENDLY TREES**  
These shorter-statured trees are suitable beneath overhead utility lines. A project of Pacific Power.

### 30 ENTRANCE TO THE ARBORETUM



## Seasonal Highlights

### December - January - February

Witch hazel, Red-osier dogwood, Hawthorn, Conifers

### March - April

Cornelian cherry dogwood, Viburnum, Magnolia, Flowering cherry, plum, crabapple, pear and peach, Redbud, Flowering dogwood, Serviceberry

### May - June

Hawthorn, Golden chain, Viburnum, Kousa dogwood, Yellowwood, wildflowers, cacti and succulents

### September - October - November

Ornamental grasses, Nuts, Larch, Color foliage of deciduous trees, such as beech, birch, dogwood, ginkgo, maple, oak, sweetgum

### Hours & Etiquette

The Arboretum grounds are open every day of the year from dawn until dusk. There is no charge for admission. The **Tree House Museum Store** and **Interpretive Center** are open Tuesday - Saturday, 9 AM to 4 PM. To Schedule a group tour or to check out a **Fresh Science** backpack, call **248-7337**.

**YES: See, Study, Stroll**  
**NO: Pets, Picnics, Play**

Visit us on the Web!  
[www.ahtrees.org](http://www.ahtrees.org)



## Yakima Area Arboretum & Botanical Gardens

## Self-Guided Tour



## Welcome!

The Arboretum is a 'living museum' of over 1000 trees, together with other plant species of forbs, grasses and shrubs on 46 acres of land managed as display gardens and a natural area.

Established in 1967 by the Central Washington Federation of Garden Clubs, the Arboretum is a nonprofit organization supported by the generosity of its members, and through the hard work and dedication of its volunteers.

**1 INTERPRETIVE CENTER**  
The tour begins at the Jewett Interpretive Center, a gift from Don & Helen Jewett of Yakima in 1992. Among its features are a carillon bell tower, The Heritage of Trees display, Wilma Walker Horticultural Library, Fred & Dorothy Plath Solarium, Thomas G. Nielsen Herbarium, Tree House Museum Store, Founder's Courtyard & Rose Druse Pergola, Meeting facilities, kitchen, restrooms, & offices.

**2 ROCK BORDER GARDEN**  
Near the Interpretive Center entrance is a rock border garden featuring native basalt rocks, garden accent lighting, ornamental grasses, native plants, and a columnar basalt memorial fountain.

**3 COMPOST DEMONSTRATION SITE**  
Within the circle of arborvitae, the Yakima County Solid Waste compost demonstration site demonstrates a variety of compost bins for yard waste, worm composting, and pet waste. Look for more information inside the circle's mailbox.

**4 POND & FOUNTAIN**  
Jewett Pond with its center fountain is framed by grasses, rushes and sedges, and by hundreds of petunias from May to September.

**5 CENTENNIAL OAKS**  
This collection was first planted on Arbor Day in 1989 as part of Washington State's Centennial. More oak specimens have since been added.

**6 JOYFUL GARDEN**  
The Japanese Garden features a wisteria gateway, tea house, pagoda, reflecting pond and waterfall. It is a favorite and frequent site for weddings. Weeping Nootka false cypresses stand against the horizon at the garden's highest point.

**7 MOUNTAIN ASH GROVE**  
The grove east of the Joyful Garden shows mountain ash along with white beam, honey locust, ash and birch.

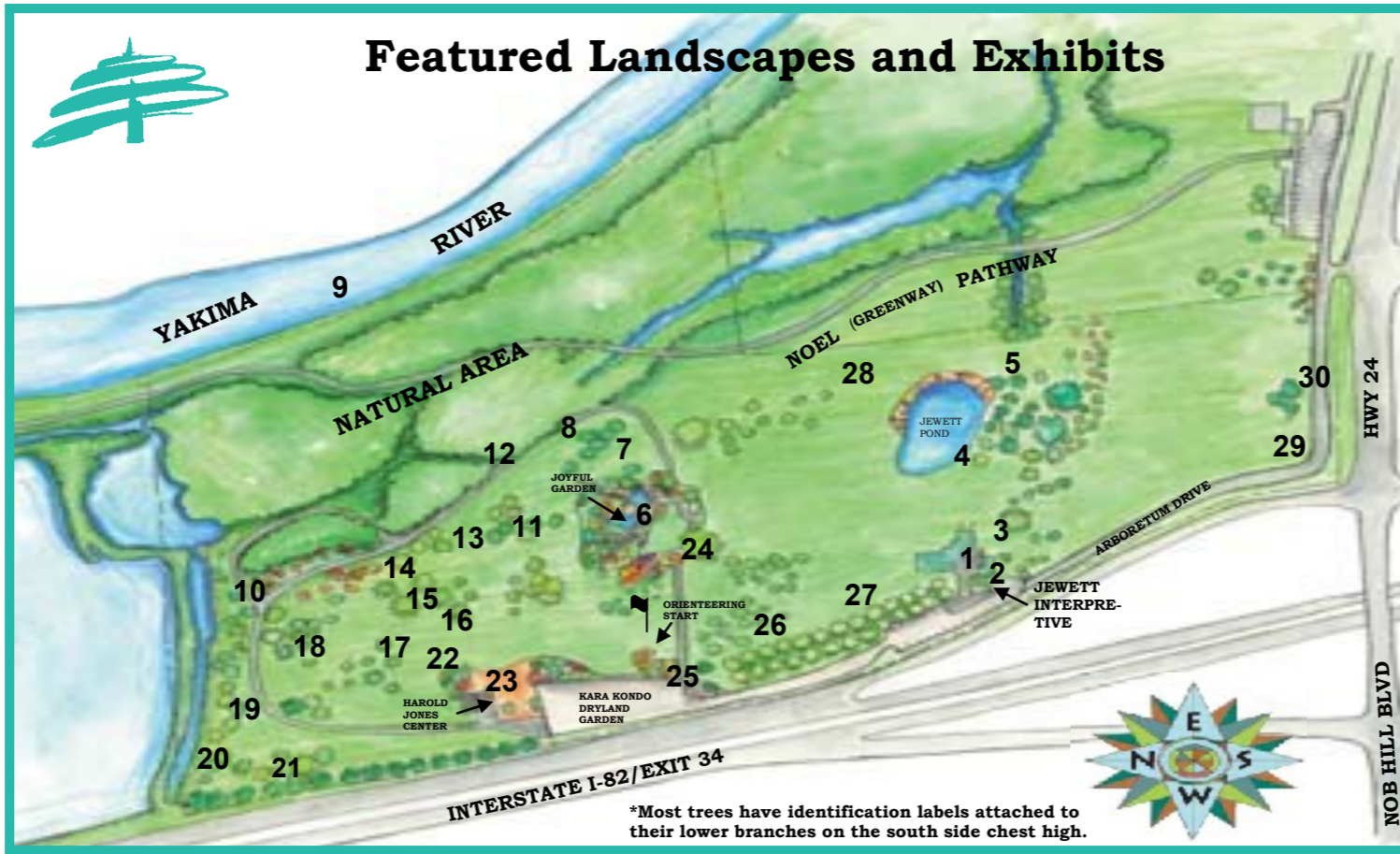

\*Most trees have identification labels attached to their lower branches on the south side chest high.

**8 EDWARD M. SCHROEDER WETLAND TRAIL**  
From its trailhead, this path winds for 1/3-mile among native wildland vegetation to the Noel Pathway and return. Look for local wildlife, trees downed by beavers, bird houses, and the red bark of red osier dogwood.

**9 YAKIMA RIVER**  
Flowing along the east edge of the Arboretum, the river is the water lifeline of the Valley. Native black cottonwood trees abound beside the river.

**10 NORTHEAST BRUSHLANDS**  
Here the wild brush and brush piles, alive and dead, offer prime habitat for birds and small animals.

**11 LINDEN COLLECTION**  
Lindens are popular shade trees. The pervasive fragrance of flowering lindens attracts bees.

**12 VIBURNUM**  
Many viburnums have showy flowers, thick foliage and brilliantly colored fruit. Migrating birds are attracted for food and shelter.

**13 TREES OF WASHINGTON**  
Dedicated on Arbor Day 1997 to Knut Lunnum, this exhibit features native trees which are capable of withstanding the extremes of Yakima's temperate continental climate (from -25° F to + 110° F).

**14 CARLSON BUTTERFLY GARDEN**  
This memorial to Barbara L. Carlson incorporates plantings of perennials and host plants in garden beds among dogwoods which are attractive to butterflies.

**15 LIVING FOSSIL**  
The dawn redwood, a prehistoric tree, existed 50 million years ago, and shared landscapes with dinosaurs.

dinosaurs. Thought to have been extinct, it was rediscovered in 1941 in a remote area of western China. An expedition there in 1944 by the Arnold Arboretum has resulted in worldwide propagation and distribution of the species.

**16 GIANT SEQUOIA COLLECTION**  
A small grove is making thrifty, symmetrical growth. This species is the most massive of trees, with great swollen red trunks and handsome pyramidal shape. A cold-tolerant tree from the high western slope of the Sierra Nevada, giant sequoia in the distant past grew in this area

**17 HAWTHORN COLLECTION**  
Both thorned and thornless species provide cover and berries, called haws, for birds.

**18 SWEETGUM COLLECTION**  
Fall foliage is exquisite for the range of color. Each of these trees was planted as a living memorial. Learn more about honoring loved ones with memorial trees by contacting the Interpretive Center.

**19 SPRUCES & PINES**  
Several evergreen conifers are represented here, including spruces with pendulous cones and pines with woody cones.

**20 FIRS**  
True firs exhibit symmetrical profiles. Generally their foliage is 'softer,' less rigid and prickly, than that of spruces. The cones grow upright and erect, and disintegrate after maturity, rather than falling intact as do those of spruce, Douglas-fir and most pines. (OVER)

## Membership

New  Renewal  Gift

### Level of Membership

Pine \$30  Walnut \$300  
 Fir \$50  Cedar \$500 +  
 Spruce \$100  Other \_\_\_\_\_  
 Business \$200

Honorarium Donation \$ \_\_\_\_\_

### Gift Membership or Honorarium for

Name: \_\_\_\_\_

Address: \_\_\_\_\_

City/State/Zip: \_\_\_\_\_

Phone: \_\_\_\_\_ Email: \_\_\_\_\_

In addition, I would like to make a tax-deductible gift to the Arboretum in the amount of \$ \_\_\_\_\_

### Payment Information

Name: \_\_\_\_\_

Address: \_\_\_\_\_

City/State/Zip: \_\_\_\_\_

Phone: \_\_\_\_\_ Email: \_\_\_\_\_

### Method of Payment:

Check  MasterCard  Discover  Visa  
 Acct. No. \_\_\_\_\_ Exp. Date: \_\_\_\_\_

Please send me information on Memorials.

I am interested in volunteering for an event or special project.

The Yakima Area Arboretum  
 Phone: (509) 248-7337 • Email: info@athtrees.org